



Baldslow Road, Hastings TN34 2EY

Offers in excess of £800,000



A charming DOUBLE FRONTED VICTORIAN VILLA positioned in an IDYLIC SETTING close to Alexandra Park. The Queens Quarter, Hastings Town centre and the beach are only a five minute walk away offering a selection of local eateries, breweries, shopping facilities and a mainline railway station with connections to London. Tastefully decorated with neutral Farrow & Ball colours, the accommodation here is presented to an excellent standard throughout offering grand proportions an ABUNDANCE OF ORIGINAL FEATURES. The bay fronted living room enjoys a WOOD BURNING STOVE and bay window which frames a bright front aspect. The dining room features an open fireplace creating a cosy space to entertain, it's partitioned from the BESPOKE KITCHEN with reclaimed glazed doors which were salvaged from a school. The kitchen is fitted with wooden units, complimented with RECLAIMED SLATE WORKTOPS, a brass DeVol tap and freestanding island with German brick factory worktop. There is a third reception room with BUILT-IN CUPBOARDS fitted with reclaimed doors from a French Chateau and bi-folding doors that open out to an area of patio. The

GROUND FLOOR
1284 sq.ft. (119.3 sq.m.) approx.

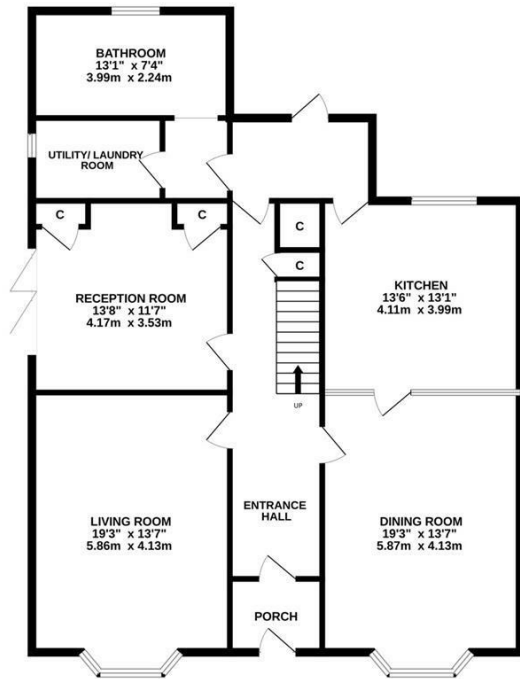

1ST FLOOR
1207 sq.ft. (112.1 sq.m.) approx.

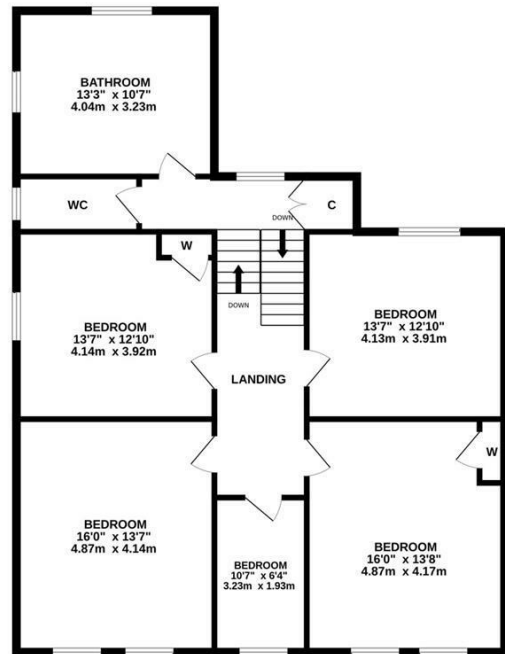

TOTAL FLOOR AREA : 2491 sq.ft. (231.4 sq.m.) approx.

Whilst every attempt has been made to ensure the accuracy of the floorplan contained here, measurements of doors, windows, rooms and any other items are approximate and no responsibility is taken for any error, omission or mis-statement. This plan is for illustrative purposes only and should be used as such by any prospective purchaser. The services, systems and appliances shown have not been tested and no guarantee as to their operability or efficiency can be given.

Made with Metropix ©2023

